

# FUZE

User Manual



Please read the manual carefully before using Fuze Card

## Getting started with Fuze Card

- First create an account on eCARD Manager App/Website then turn the card on by pressing the power button once. (<http://www.brilliantts.com>)
- Please check Fuze Card and charging eCHARGER's battery levels and fully charge before using them.
- Please make sure Fuze Card is in its charging eCHARGER during firmware updates and turned on.
- Always have Fuze Card in its charging eCHARGER when updating.

Download and install the eCARD Manager App from the Google Play Store or iOS App Store onto your smartphone and follow the instructions.



<Fuze Card M Type>

\*M Type is available for magnetic stripes, barcodes exclude EMV chip.

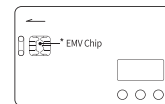

<Fuze Card A Type>

\*A Type is available for magnetic stripes, barcodes include EMV chip.

\* To use Fuze Card M Type on POS terminals with EMV chip reader, first insert Fuze Card into EMV chip reader then swipe the magnetic stripe on POS.

## Safety Caution

- Do not place heavy objects on top of Fuze Card.
- Do not deliberately bend the card. Parts inside could get damaged.
- Keep Fuze Card away from flammable sources.
- Keep Fuze Card away from water, alcohol and Benzene etc.
- Keep Fuze Card away from humid and dusty conditions.
- Keep Fuze Card away from magnetic products.
- Do not disassemble or modify Fuze Card on your own.
- To dispose of Fuze Card, cut along the dotted lines on back side of product.
- Keep Fuze Card in its charging eCHARGER while updating firmware.
- Do not use Fuze Card in humid places. (eg.Sauna, Spa)
- Sign your signature on Fuze Card with an oil-based pen.
- In low temperature conditions, the display may show a slight after image.
- The magnetic stripe emulation component meets international standard ISO 7816.
- Fuze Card may not be compatible with some POS depending on its terminal type.
- Fuze Card may not be compatible with some POS that are compliant with JIS X6302.

## Features and Role of Fuze Card

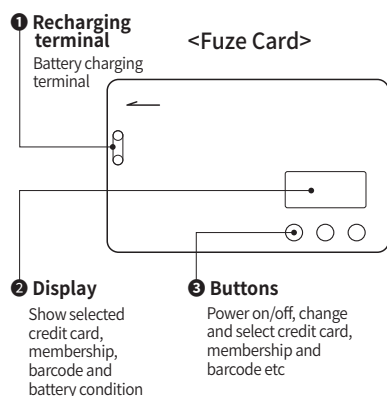

- 1 Power/Change the selection(Left)**  
Press and Hold down button to turn ON/OFF the card. Simply press button to select card to the left.
- 2 Hold the current card Change the selection(Right)**  
Press and Hold down button to lock current card on the display. Simply press button to select card to the right.
- 3 Change the Mode**  
Press and hold down button to go into multi display Change the payment and membership type by simply pressing the button.

<Please note that the functionality of the control buttons may be changed after you upgrade the software. For more information about buttons and display, please check our website or App.>

## Features and Role of Fuze Card

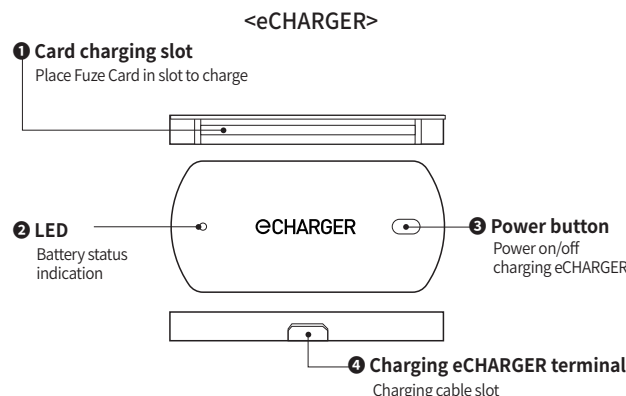

eCHARGER can double as a portable charger for your Fuze Card with built-in battery.

## Features and Role of Fuze Card

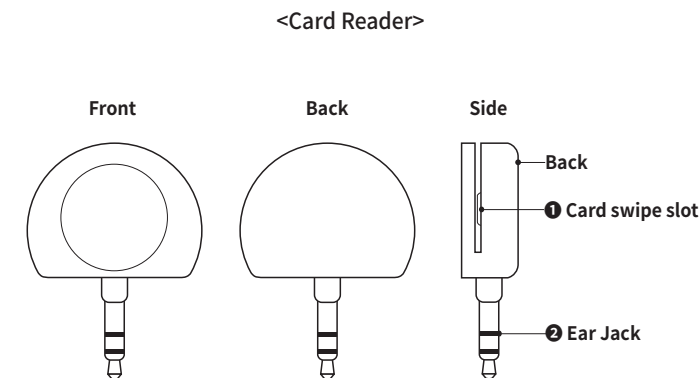

## How to charge Fuze Card

- 1) Insert Fuze Card into the charging eCHARGER and push the power button on the eCHARGER. A LED light will turn on when it starts to charge.
- 2) The light will change color to indicate charging level.

LED	Status
Red	Charging
Green	Fully Charged
Orange	Error

- \* Charge eCHARGER using a standard micro-USB charging cable.
- \* LED light (Green) will turn off 15seconds after it is fully charged.

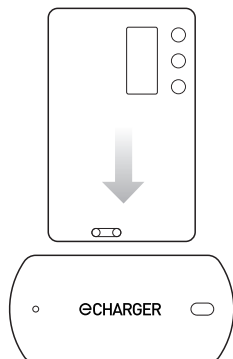

## Connect with eCARD Manager

1. Download the App, eCARD Manager, from the Google Play or App Store.
  2. Open the eCARD Manager and follow instructions to register.
  3. Power on Fuze Card and connect with the App.
  4. Fuze Card is ready for use now.
- \*\*\* If you can't connect Fuze Card with your smartphone restart the App.



You can find more information on eCARD Manager. Follow the detailed instructions carefully when registering your Fuze Card.

\*\*\* Please maximize the media volume of your smartphone when registering the card. \*\*\*

## How to Add a Payment / Membership Card

- 1) Insert the card reader**  
Insert the card reader into the Ear jack port and start your App.
- 2) Add your Card**  
Follow the instructions in the eCARD Manager App and swipe the card on the magnetic stripe.

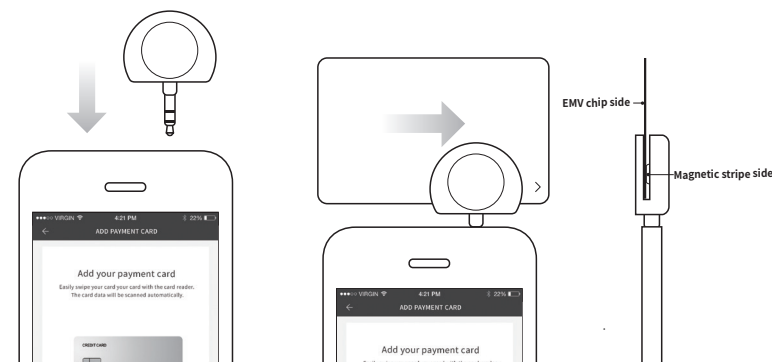

- This is an electro magnetic compatible product. It is a home electronic device and it can be used anywhere in the world.
- This device uses wireless equipment. During the operation, it may have electrical wave interference so it should not be used for life-saving related services.
- Changes or modifications not expressly approved by the party responsible for compliance could void the user's authority to operate the equipment.
- NOTE : This equipment has been tested and found to comply with the limits for a Class B, Digital device, pursuant to part 15 of the FCC Rules. These limits are designed to provide Reasonable protection against harmful interference in a residential installation. This equipment generates, uses and can radiate radio frequency energy and, if not installed and used in accordance with the instructions, may cause harmful interference to radio communications. However, there is no guarantee that interference will not occur in a particular installation. If this equipment does cause harmful interference to radio or television reception, it can be determined by turning the equipment off and on, the user is encouraged to try to correct the interference by one or more of the following measures :
  - Reorient or relocate the receiving antenna.
  - Increase the separation between the equipment and receiver.
  - Connect the equipment into an outlet on a circuit different from that to which the receiver is connected.
  - Consult the dealer or an experienced radio / TV technician for help.

Card battery	3.8V / 13mAh , Lithium-Polymer, Rechargeable
Standby time	The usage time of the card may vary depending on the safety mode you choose (Refer to the App or Homepage)
Charging time	About 1 and half hour
eCHARGER rated voltage / Current	Input DC 5.0V / Output DC 4.35V / 12mA / 40mAh
Operating temperature	14°F ~ 122°F / -10°C ~ 50°C
Size / Weight	eCARD size 3.36in. x 2.13in. x 0.2 oz / 0.01lb 85.5mm x 54mm x 0.8mm / 6g
	eCHARGER size 2.87in. x 1.38in. x 0.56 oz / 0.04lb 73mm x 35mm x 0.75mm / 16g
	Reader size 1.85in. x 1.18in. x 0.25 oz / 0.02lb 47mm x 30mm x 11mm / 7g
Display	1.1 inch E-paper display

- Corporate Name : BrilliantTS Co.,Ltd.
- Item title (Model name-Device) : Low power radio equipment and associated ancillary equipment for wireless data communication systems, BPAY-CAG-01 / BPAY-CMG-01
- Item title (Model name-Device) : eCHARGER, BPAY-BTC-02
- Rechargeable Li-ion : LICP3/13/43
- Manufacturer / Country of Origin : BrilliantTS Co.,Ltd. / Korea
- Manufacturing date :
- Safety Number :

BPAY-CAG-01	BPAY-CMG-01
MSIP-CRM-BRS-BPAY-CAG-01	MSIP-CRM-BRS-BPAY-CMG-01
FCC: 2AK3-BPAY-CAG-01	FCC: 2AK3-BPAY-CMG-01
* This device complies with part 15 of the FCC Rules.	

- Battery will last longer with proper care and maintenance.
- Long periods of non-use may result in a decrease of battery life span.
- Keep product away from temperatures over 35°C (95°F) and under -5°C (23°F).
- To maximize battery capacity, use in room temperature.
- Using the product in low temperatures may result in less battery life.

**Service Center**

- Service Center **support@fuzecard.com**
- Fuze Website **http://www.fuzecard.com**

You can find more information on the website

### Button Guide

	POWER	HOLD	MULTI
<b>Single Press</b>	Left	Right	Fuze Card group selection (payment / membership)
<b>Hold for 3 sec</b>	Power	Hold mode	Multi display (payment + membership)
<b>Hold both buttons for 3 sec</b>	<b>Magnetic wave</b>		
	<b>FUZE Card Information</b>		

#### ▶ Power on

POWER  
Press to turn the power on



#### ▶ Card group selection (payment/membership)

MULTI  
Press to toggle between two card groups

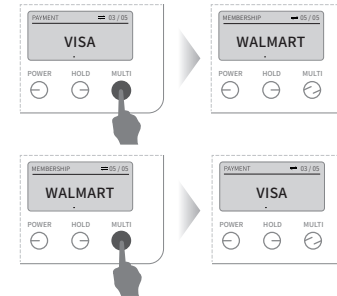

#### ▶ Select payment card

HOLD  
Press to move right

POWER  
Press to move left

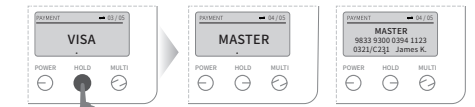

Specific card data automatically appears after 3 sec.

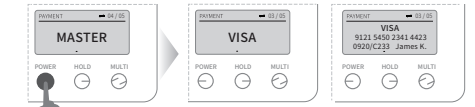

Specific card data automatically appears after 3 sec.

#### ▶ Select Membership card

HOLD  
Press to move right

POWER  
Press to move left



Specific card data automatically appears after 3 sec.



Specific card data automatically appears after 3 sec.

#### ▶ Multi Display

\*Magnetic stripe holds payment card data, while E-paper displays membership barcode.

MULTI  
Hold for 3 sec to enter / exit multi display mode

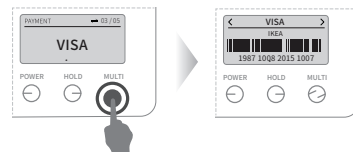

MULTI  
Press to toggle between payment cards / membership cards

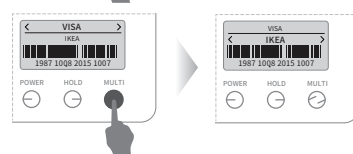

POWER  
Press to move left

HOLD  
and to move right

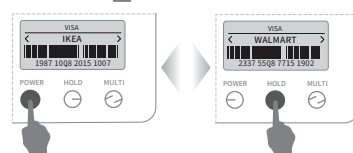

#### ▶ Hold mode

HOLD  
Hold for 3 sec to enter Hold mode (Hold current payment card on display for 10min)

\* E.g when handing over to a restaurant server

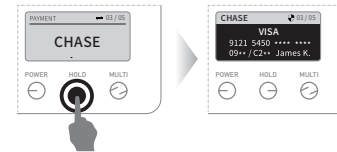

#### ▶ Magnetic wave

POWER HOLD  
Hold and for 3 sec to activate Magnetic wave mode (Used when the card is completely inserted into a machine)

\* E.g ATM / Gas Station  
\* It may have more power consumption

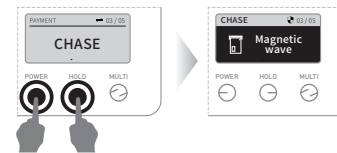

#### ▶ Information

POWER HOLD  
Hold and for 3 sec to access card information

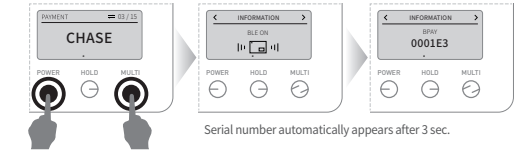

Serial number automatically appears after 3 sec.

HOLD  
Press to navigate through card information

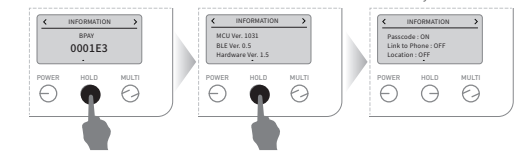

\* Version status

\* Security status